

---

# TESSERA

---

## PROJECT OVERVIEW

The homes at Tessera are built to the highest standards, embracing quality, value and energy efficiency. At Homewise Homes,<sup>®</sup> we believe *everyone* deserves to live well.

**There are several floor plans to choose from, with two, three and four bedrooms.**



SUNROSE MODEL HOME

*Rendering is for visual aid only.*

---

## Community Features

- Less than six miles from the Santa Fe Plaza
- Breathtaking mountain views to the south, east and west
- Extensive trail system throughout the community
- Generous dedicated open space
- Set within the school districts of Gonzales Community School and Capital High School
- Santa Fe County water and sewer systems, PNM electric and New Mexico Gas Company

---

For more information  
call Dianne McKenzie ☎  
505.603.9300



# TESSERA

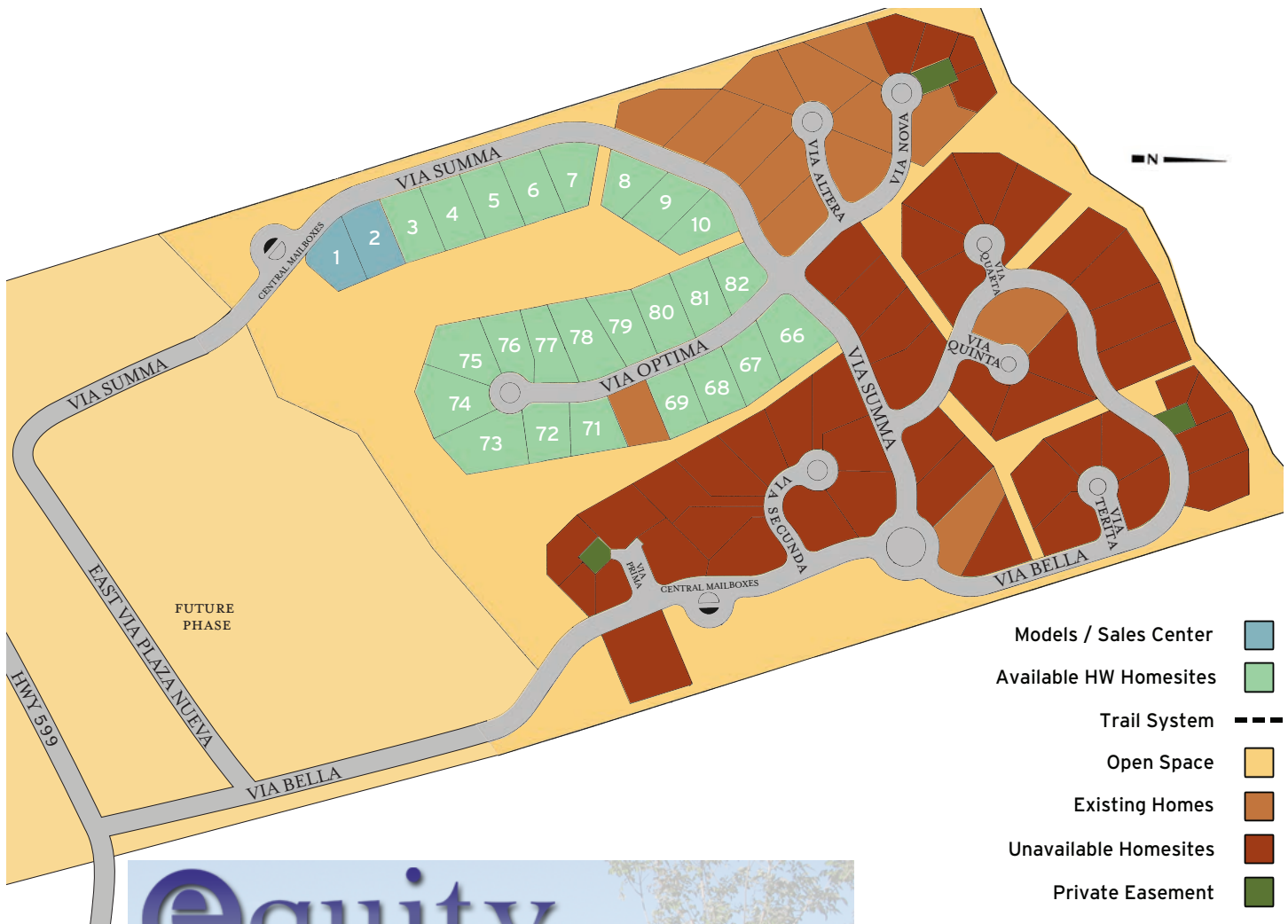

**Equity**  
NEW MEXICO

Dianne McKenzie  
Associate Broker  
Cell: 505.603.9300  
Office: 505.291.0050  
Fax: 505.995.0075

[www.RealEstatePropertiesSantaFe.com](http://www.RealEstatePropertiesSantaFe.com)  
Dianne@RealEstatePropertiesSantaFe.com  
on Aldea Plaza 19 Plaza Nueva, Santa Fe New Mexico 87507



**homewise®**  
HOMES

**Homewise, Inc. 1301 Siler Rd., Bldg. D Santa Fe, NM 87507 505.983.WISE (9473) [www.homewise.org](http://www.homewise.org)**

*Income or other restrictions may apply. Elevations shown are artist concepts. Floor plans may vary per elevation. All room sizes are approximate; consult blueprints for specific details. Continuing a policy of constant research, design and improvement, Homewise Inc. reserves the right of price, plan and specification change without notice or prior obligation. Please check with Real Estate sales personnel to determine which lots are available for a specific house plan.*

HW3573 8/12/14