

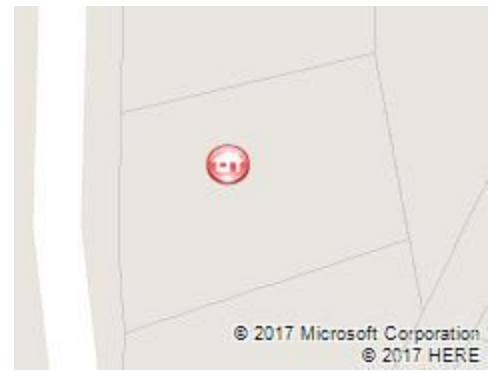

# RESIDENTIAL LAND

## \$77,500

### Active



**136 Avenida Frijoles**

**Santa Fe NM**

**MLS #: 201700370**

**County:** Santa Fe

**Unit #/Building:**

**Area:** 25S- NW Quadrant-S

**Listing Date:** 1/26/2017

**Days on Market:** 272

**Board:**

Santa Fe MLS

Listings as of:

10/25/2017

Property Information				Financial Information	
<b>Tax Parcel</b> 910016827	<b>Lot Size Acres</b> 0.200000	<b>Distance From Paved Road</b>		<b>Auction</b>	
<b>Unit #/Building</b>	<b>Price Per Acre</b> \$387,500.00	<b>Distance To Water</b> onsite		<b>Bank Owned</b> No	
<b>Property Subtype</b> Residential Lot	<b>Lot Size Sq Ft</b> 8712	<b>Distance To Gas</b> onsite		<b>Short Sale</b> No	
<b>Zoning</b> PUD	<b>Lot Size Source</b> Tax Data	<b>Distance To Electric</b> onsite		<b>Trade</b> No	
<b>Approx. Size</b> .125-.25 acre	<b>Lot Dimensions</b>	<b>Distance To Phone</b> onsite,		<b>Taxes \$</b> \$531.68	
<b>Covenants And Restricts</b> Yes	<b># Of Approved Lots</b>	underground		<b>Tax Year</b> 2015	
<b>Mobile Homes Allowed</b> No	<b>Wells</b>	<b>Boundary Marks</b>		<b>Seller's Representative</b>	
<b>Improvements</b> No	<b># Shared Wells</b>	<b>High Elevation</b>		Dianne McKenzie Kachina Mountain Realty	
<b>Utilities Available</b> Yes	<b>State Registered</b>	<b>Low Elevation</b>			
<b>Water Rights Available</b> No		<b>Topography</b>			
		<b>Shape</b>			
		<b>Flood Zone</b>			

Property Description:
Amazing elevated view lot with south views to the Ortiz & Sandia Mountains across open space green belt with arroyo sunset views. Lot #378, 134 Avenida Frijoles is also for sale. Aldea Community provides 205 acres of open space with 13 miles of walking trails, basketball & tennis courts, community center, (which offers yoga classes, exercise equipment & gathering space for events), a local cafe, all just 10 minutes from downtown Santa Fe.

Property Features:	
<div><div>Gas</div><div>Natural</div></div> <div><div>Electric</div><div>Public, Underground</div></div> <div><div>Sewage</div><div>City</div></div> <div><div>Telephone Landline</div><div>On-Site, Underground</div></div> <div><div>Water Supply</div><div>County</div></div> <div><div>Community Amenities</div><div>Athletic Facilities, Club House, Tennis</div></div> <div><div>Documents on File</div><div>Covenants, Seller's Disclosures, Tax Levy Certificate, Survey/Plat</div></div> <div><div>Terms</div><div>Cash, Conventional, New Loan</div></div> <div><div>Authority</div><div>Santa Fe County</div></div> <div><div>Possession</div><div>Upon Funding</div></div>	<div><div>Description</div><div>Views</div></div> <div><div>Waterfront</div><div>None</div></div> <div><div>Cable TV</div><div>On-site, Underground</div></div>



**Dianne McKenzie**  
**CELL: 505-603-9300**  
**Kachina Mountain Realty - Ofc: 505-603-9300**  
**Dianne@KachinaMountainRealty.com**  
**KachinaMountainRealty.com**



Web: RealEstatePropertiesSantaFe.com | Email: Dianne@RealEstatePropertiesSantaFe.com



**More Photos**

**Address #/Dir/Street Name** 136 Avenida Frijoles

**MLS #**

201700370



**Dianne McKenzie**

**CELL: 505-603-9300**

**Kachina Mountain Realty - Ofc: 505-603-9300**

[Dianne@KachinaMountainRealty.com](mailto:Dianne@KachinaMountainRealty.com)

**KachinaMountainRealty.com**

Web: [RealEstatePropertiesSantaFe.com](http://RealEstatePropertiesSantaFe.com) | Email: [Dianne@RealEstatePropertiesSantaFe.com](mailto:Dianne@RealEstatePropertiesSantaFe.com)



Equal Opportunity Housing \* All information deemed reliable, but not guaranteed. All information herein has not been verified and is not guaranteed.